



*Spectacular Year-Round Lake Home
Turn Key: Move in + Enjoy!*



**WHITESHELL
PROVINCIAL PARK**

*Betula Lake
Block 4 Lot 11*

\$697,000

*Louise Sampson, Broker
Sampson's Realty Group
Cottage: 204-369-5212 / Cell: 204-794-7473
sampsons@mymts.net / www.sampsonsrealty.com*



The House:

- * 1700 SF Stunning Year-Round Lake House
- * Kitchen designed for a "Chef"
- * Built in cook top, microwave, oven + dishwasher
- * Large island-style kitchen: open concept
- * Great Room (Living Rm, Dining Rm, Kitchen) c/w OFP & vaulted ceiling
- * Family Room with wall of windows c/w OFP & cathedral ceiling
- * 2 Antoinette Wood Fireplaces with Lifting Door by Valcourt
- * 4 Bedrooms
- * Bathroom with 2 sinks + tub/shower
- * Mainly Pine Interior
- * Raised Pine Ceilings
- * Plank Laminate Flooring

The Trimmings:

- * 800 SF (approx.) of composite decks
- * Of which, 200 SF deck space has a roof over top
- * Hot tub on front deck
- * Roll in - Roll out dock system
- * 24 x 24 ft Garage

The Mechanics:

- * 2x6 construction
- * Double pane windows
- * Central air
- * Forced air electric furnace
- * Plumbed + wired for washer/dryer
- * Hardie Board siding
- * Metal roof
- * Year-round water system c/w water softener & UV filtration system
- * Drilled well
- * 1500 gallon holding tank for sewage+ grey water
- * 200 AMP electrical service

The Lot:

- * Sand at the waterfront
- * Flat and gently sloping property
- * East-facing: watch the sun rise!
- * Lot size: 95'(E), 163.5'(W), 151.85'(N), 156.6'(S)

The Lease:

Fees: \$1719.86 (04/01/2018 to 03/31/2019)

Renewal: 2026



The information contained herein has been obtained through sources deemed reliable by Louise Sampson & Sampson's Realty Group but cannot be guaranteed as to its accuracy. The buyer is advised to obtain independent verification of any information which is of material interest to them.

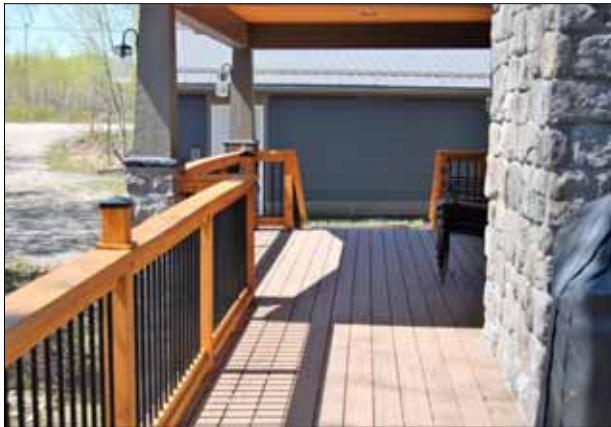





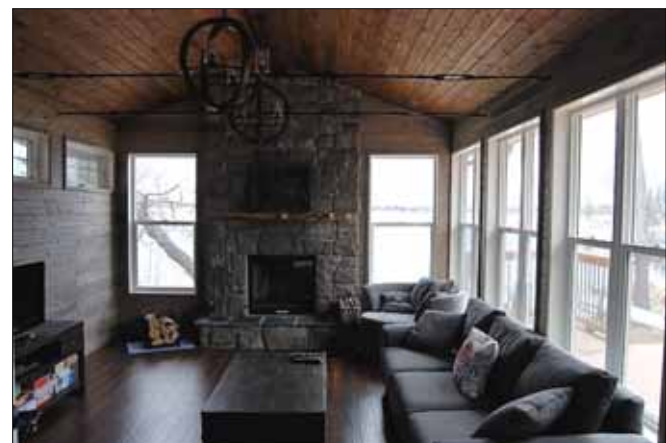







BETULA LAKE

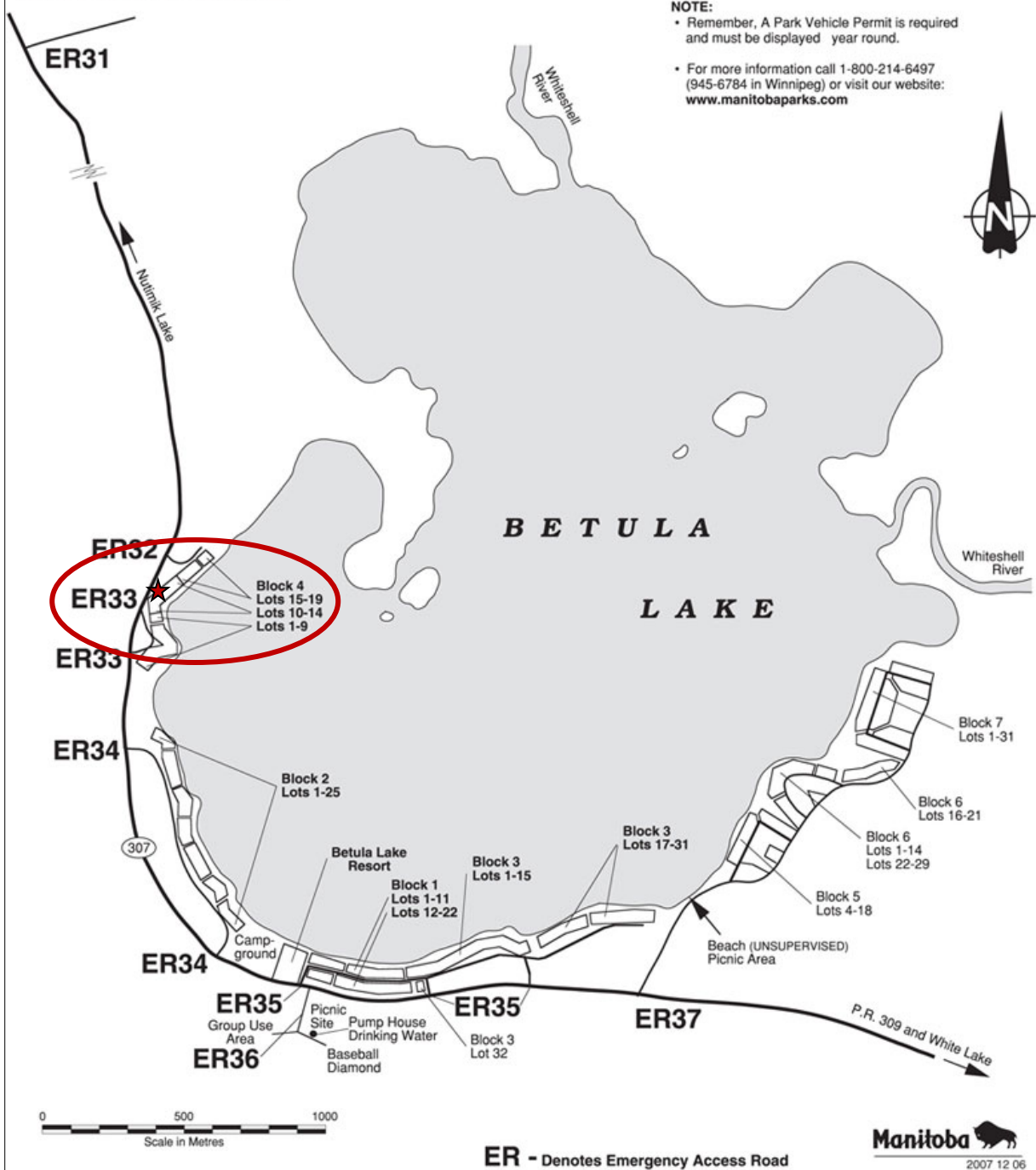

Louise Sampson, Broker
Sampson's Realty Group
 Cottage: 204-369-5212 / Cell: 204-794-7473
sampsons@mymts.net / www.sampsonsrealty.com

The information contained herein has been obtained through sources deemed reliable by Louise Sampson & Sampson's Realty Group but cannot be guaranteed as to its accuracy. The buyer is advised to obtain independent verification of any information which is of material interest to them.